

Glue the two F10
interplane struts
permanently
to both wings.
Attach both wings
to fuz with rubber bands

Slit cen
hinge wi

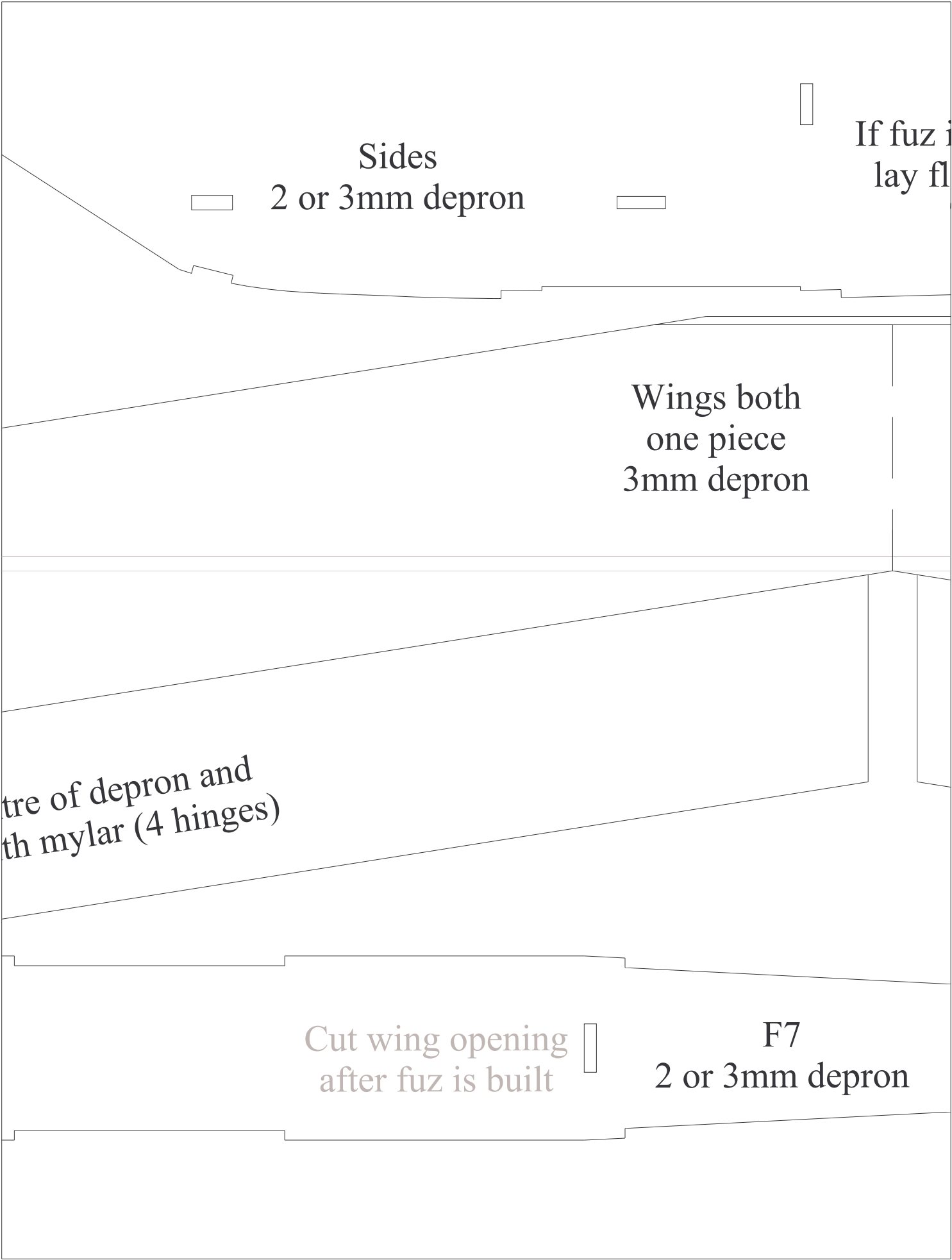

Sides

2 or 3mm depron

If fuz is
lay fl

Wings both
one piece
3mm depron

tre of depron and
th mylar (4 hinges)

Cut wing opening
after fuz is built

F7
2 or 3mm depron

Directions:

is assembled with slow-setting glue, hold together with tape and
at on one side on table and measure gap between fin and table.
Turn over onto other side and ensure gap to fin is similar.

This gives a straight fuz.

3mm hollow carbon
spar bottom wing only

Ailerons
3mm depron





Rudder
3mm depron

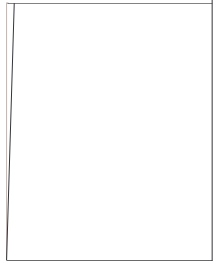

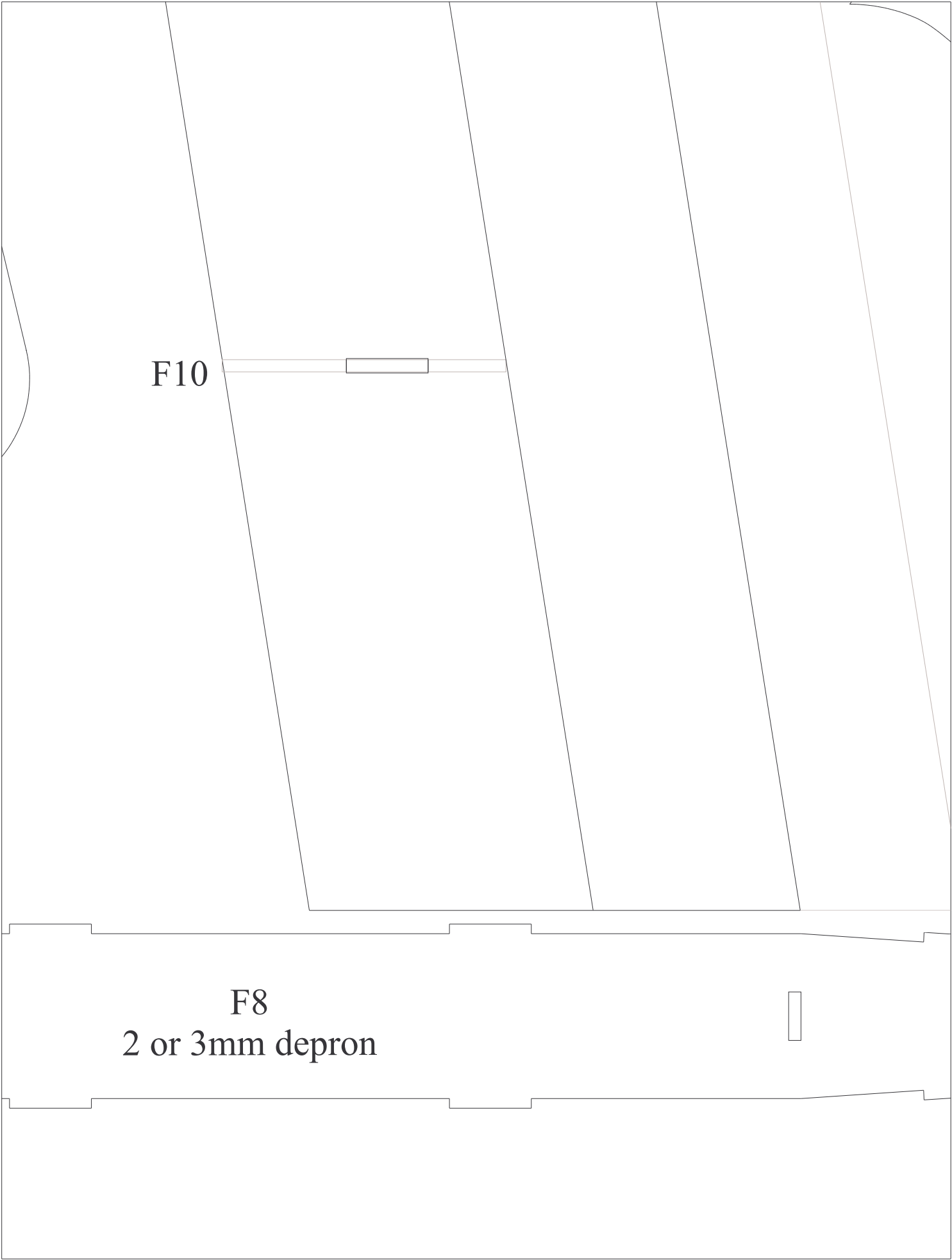

F10

F8
2 or 3mm depron

hatch/painting

F2
2mm
liteply

F3
3mm depron

Tailplane
3mm depron

F9
3mm
depron

Score underside
here

on

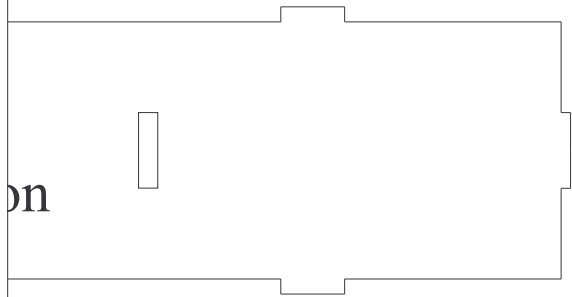

F1
3/32
hard ply

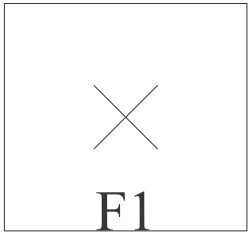

F6
3mm depron

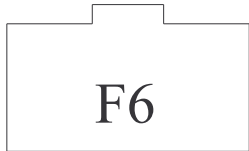

The two F9 cabane struts
mount near the sides of the fuz
and angle in to join in the middle
(to make an 'A' frame)

F1

Rx hatch

F2

F3

1/64" ply
doublers inside fuz

1.2mm wire
under-carriage

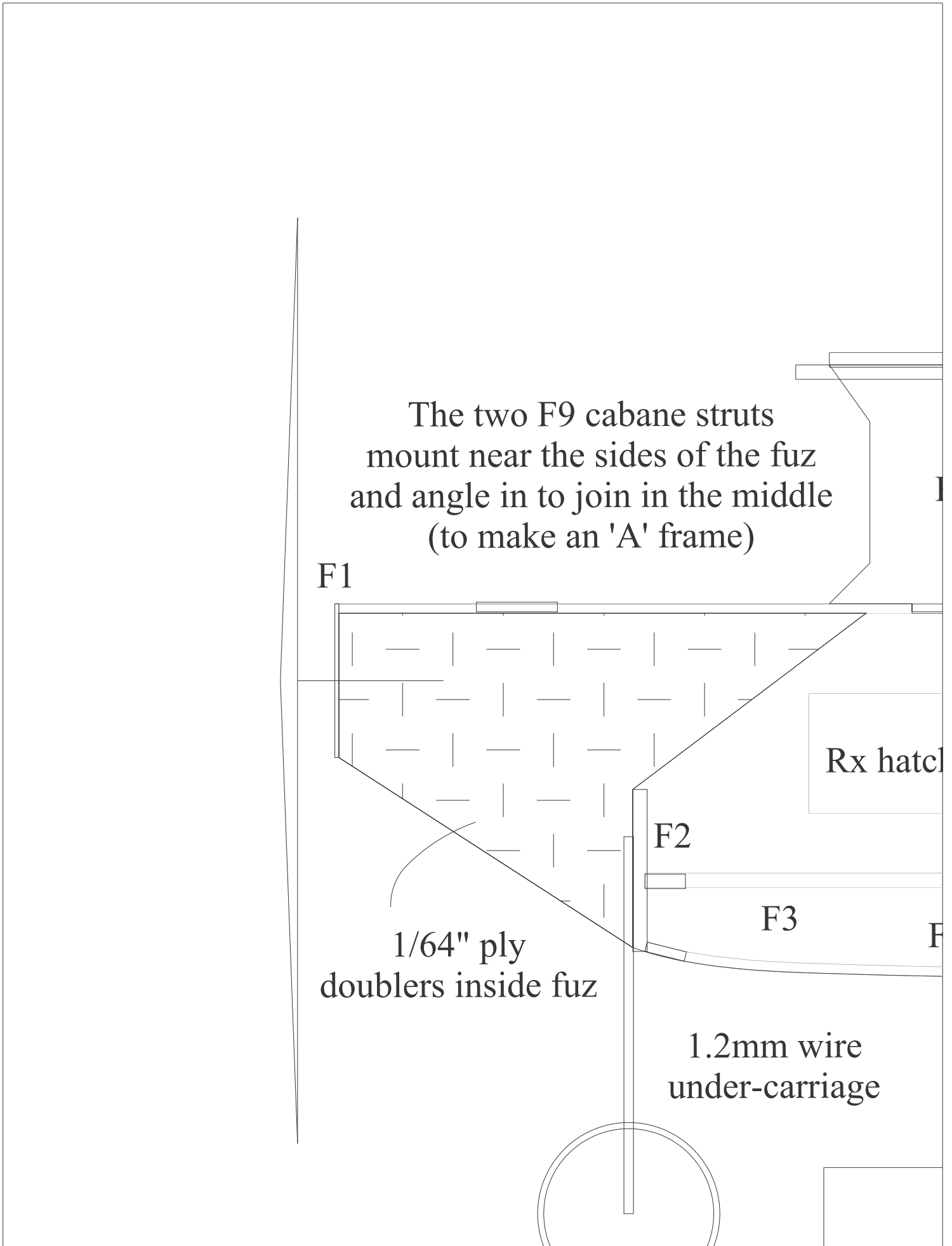

Control mover
Max possible
(with 40-60% exp

F9

F8

3x340-860mAh
LiPol pack

6g Elevator
servo

h

F5

F4

9g Aileron
servo

6g Rudder
servo

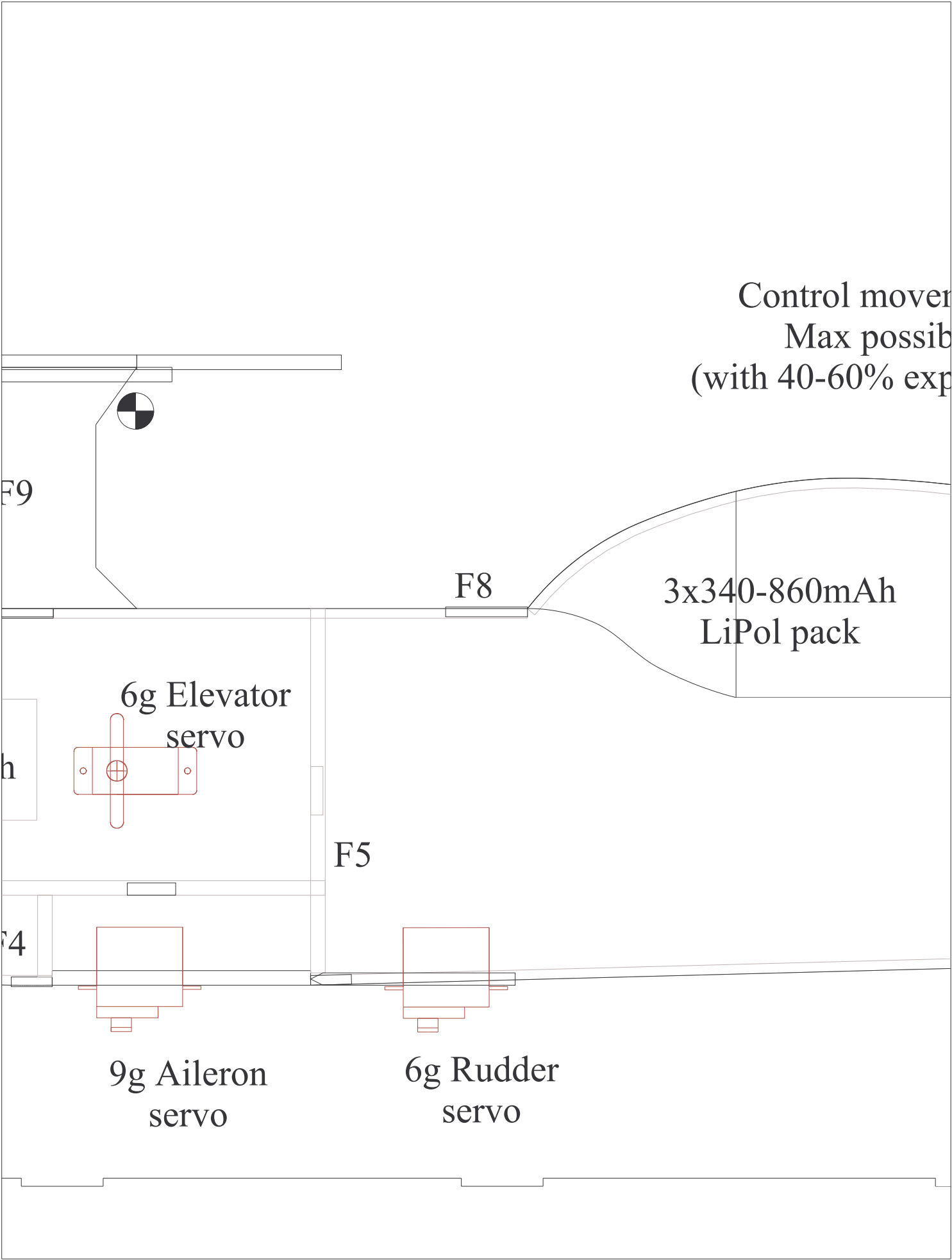

lements:
le!
ponential)

'Ultimate 10-300' - small
Copyright David Theunissen
v3 (20Mar2005)
www.flyelectric.ukgateway.net

25.3" span, 200" wing area

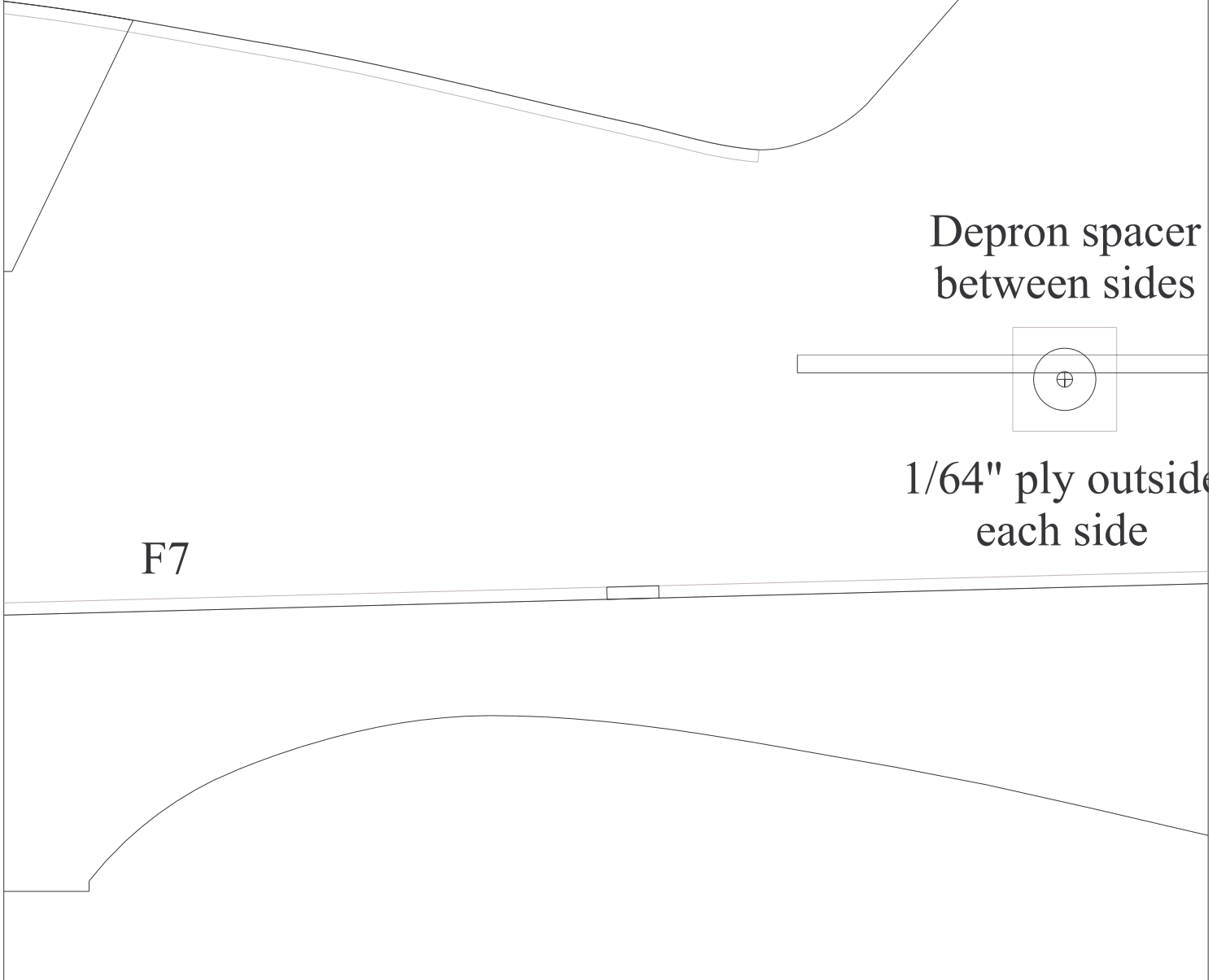

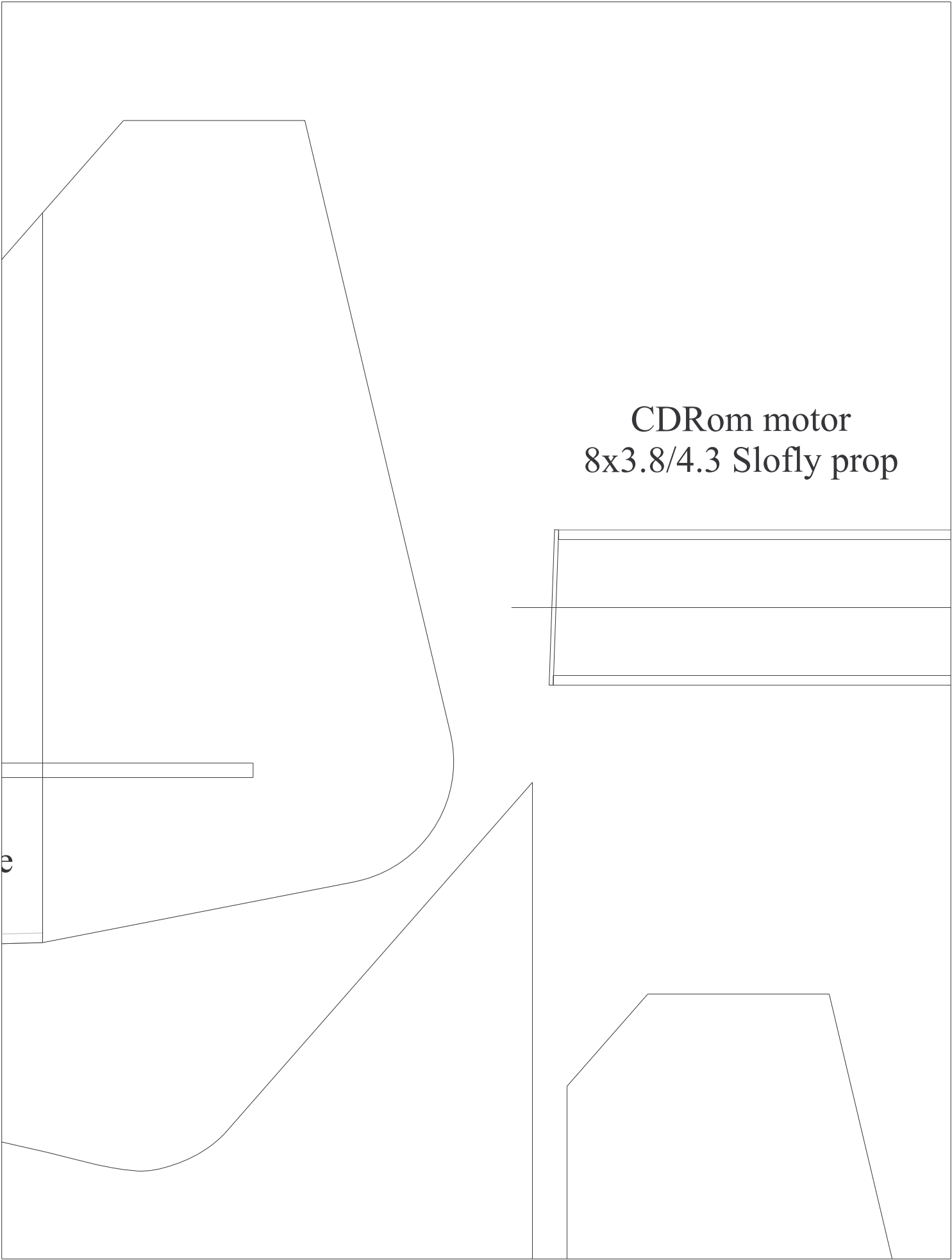

CDRom motor
8x3.8/4.3 Slofly prop

e



2mm
carbon
leading
edge

1/64"

100mm

200mm

' ply (x2)

F10
3mm
depron

F5
3mm
depron

Template for

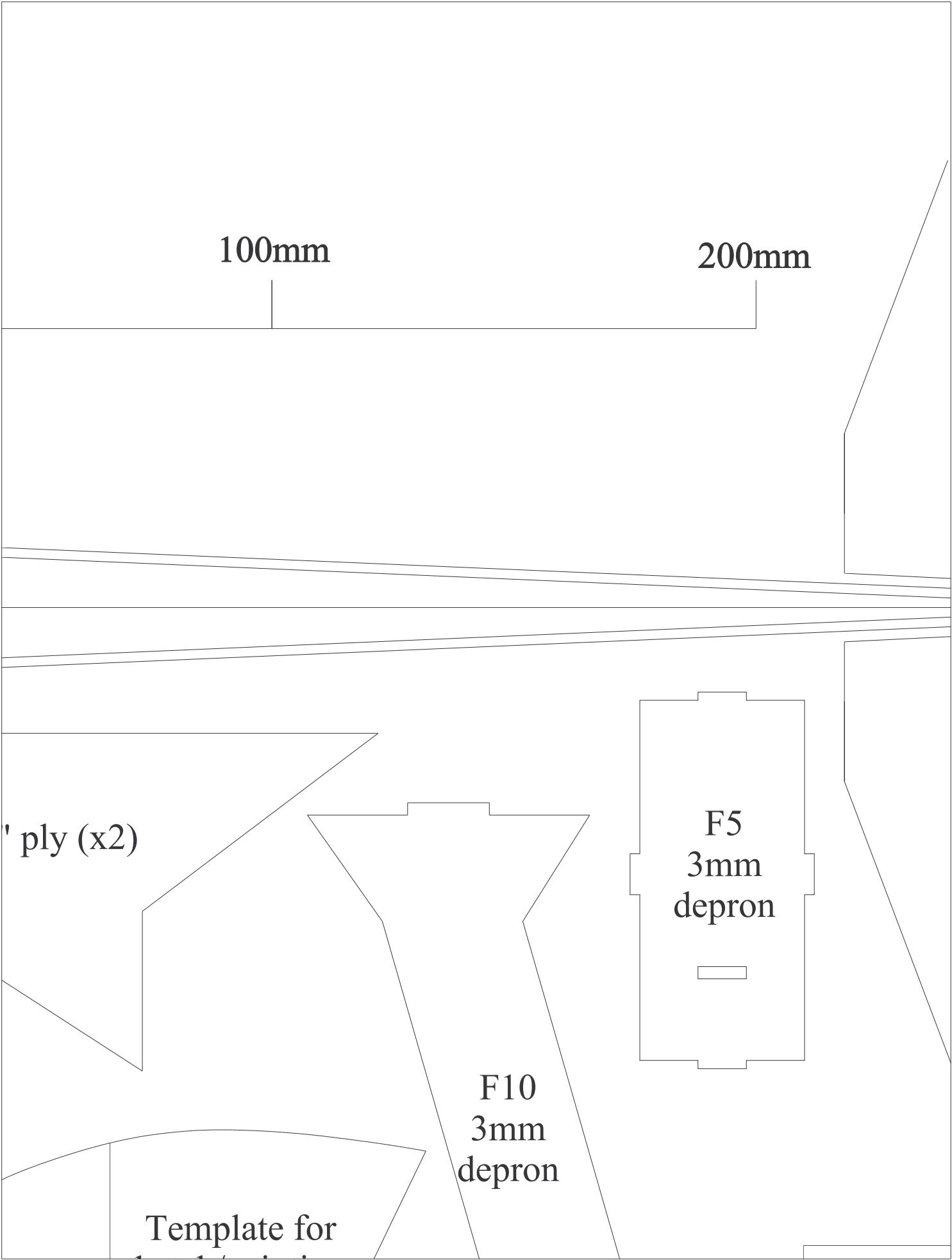

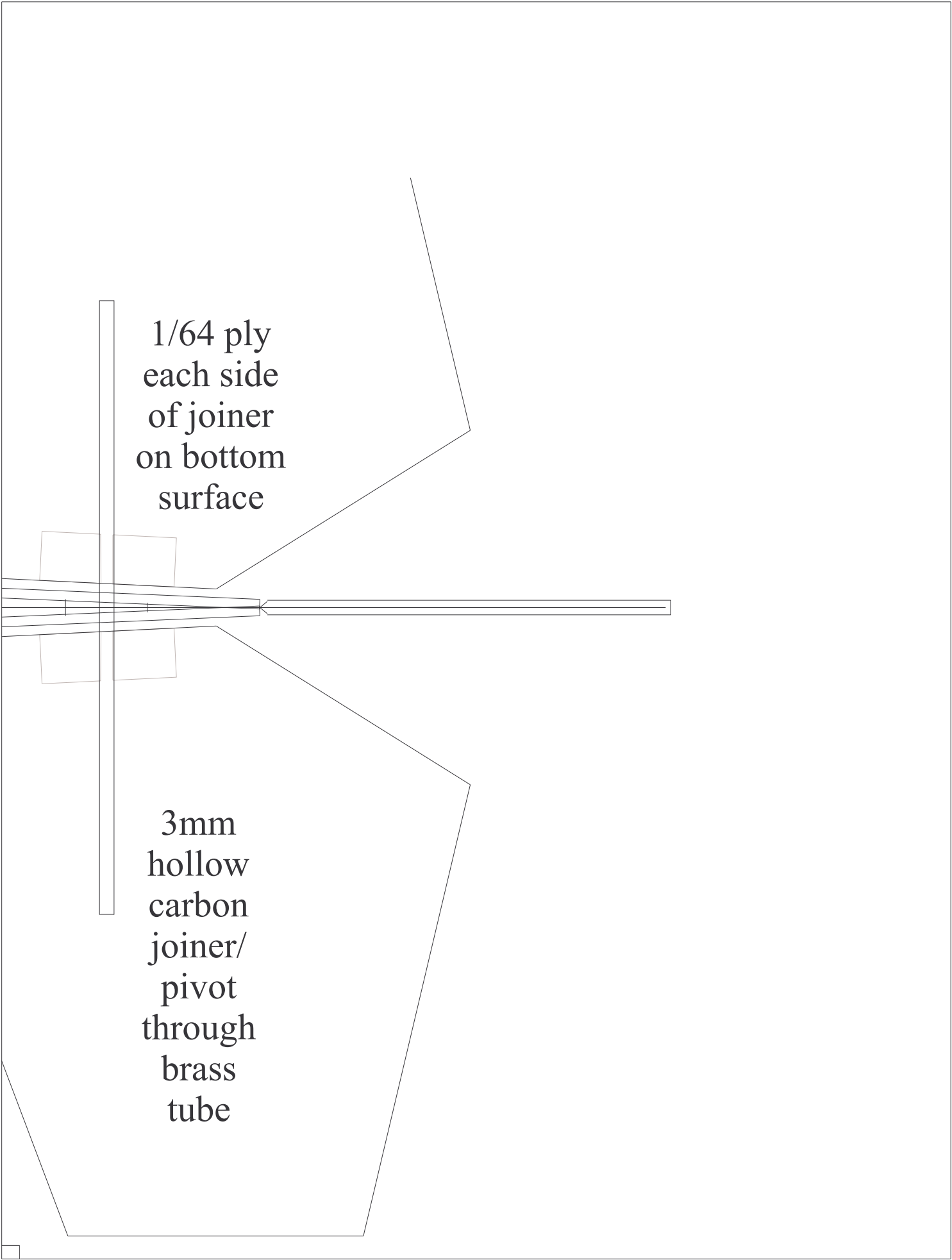

1/64 ply
each side
of joiner
on bottom
surface

The diagram shows a technical drawing of a mechanical assembly. A central horizontal component, labeled as a 3mm hollow carbon joiner/pivot, passes through a vertical brass tube. The joiner has a tapered section on its left end. Two trapezoidal shapes are positioned on either side of the tapered section, with thin layers of material (1/64 ply) on their bottom surfaces. The entire assembly is shown within a rectangular frame with a small square symbol in the bottom-left corner.

3mm
hollow
carbon
joiner/
pivot
through
brass
tube